

## Function

Flush, wall mounted, electronic water level sensor automatically monitors quick fill or safe-off functions. Low voltage for safety. Connects to Crystal Fountains' "ECL" series control panel.

## Specifications

Construction shall be cast bronze frame with impact resistance stainless steel cover and moulded plastic enclosure. Brass and stainless steel fitted. Gasket and seal shall be neoprene. Sensor shall be reed switch enclosed in a polypropylene, magnetically actuated float with 1" level adjustment.



	No. of Sensors	Cover Material	Part No.
Quick Fill or Safe-Off	1	Stainless Steel	<b>ESP100</b>

Electrical conduit connection: 3/4" n.p.t./b.s.p.

Voltage and current ratings:  
24 VAC/DC, 0.28A

## Option

AWO C70 - Vandal resistant driver kit, includes 6 S/S fasteners

## Notes

1. UL and ULC listed.
2. For use in Class 2 circuits only.
3. Wiring methods must comply with Class 3 or better circuits

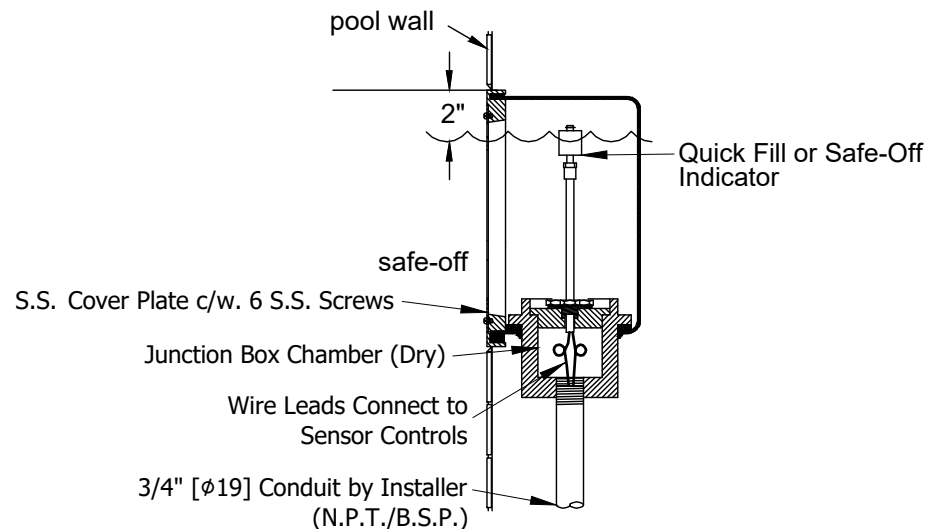
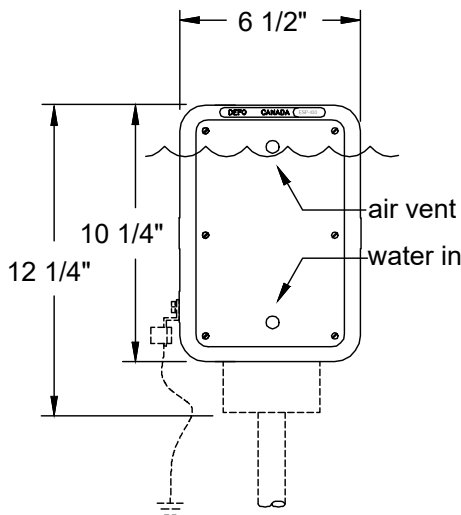

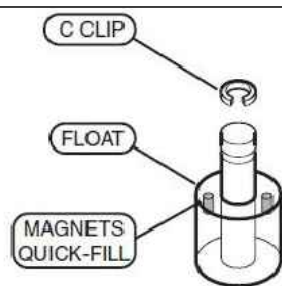
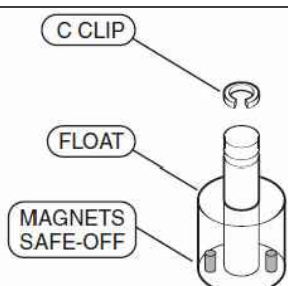

ADJUSTABLE BRASS STEM

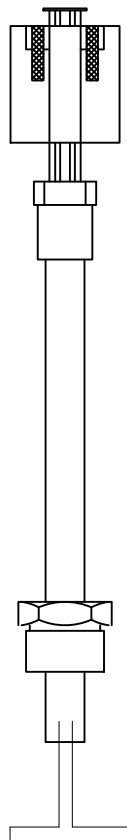
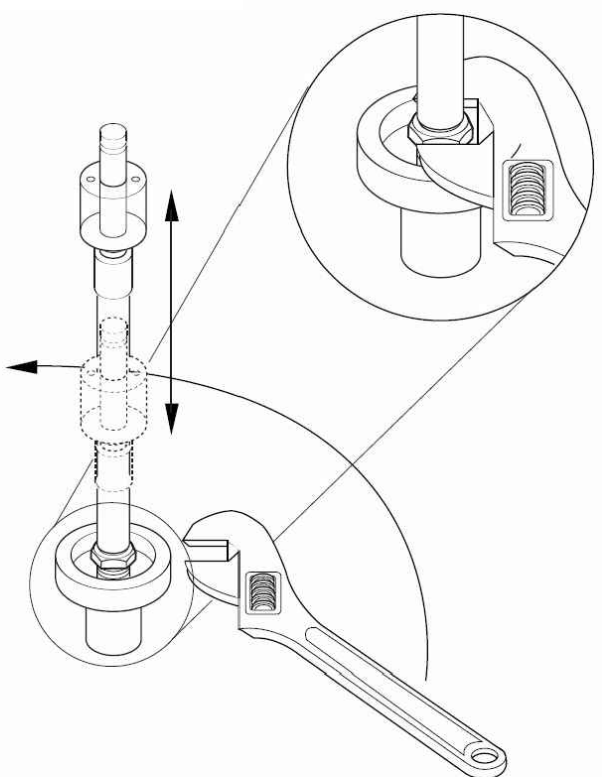
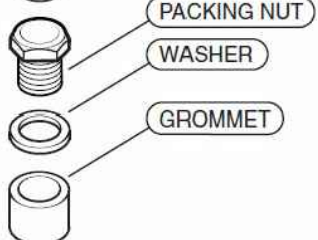

Common Wire  
Quick Fill or Safe-Off / Low Water Level

To adjust the height of the sensor, simply loosen the packing nut and raise or lower the brass stem. Re-tighten the packing nut after the adjustment.